

© Whittam Cox Architects - Disclaimer
 This drawing is copyright of WCEC Group Ltd trading as Whittam Cox Architects, and shall not be reproduced nor used for any other purpose without the written permission of the Architects. This drawing must be read in conjunction with all other related drawings and documentation. It is the contractor's responsibility to ensure full compliance with the Building Regulations. Do not scale from this drawing, use figured dimensions only. It is the contractor's responsibility to check and verify all dimensions on site. Any discrepancies to be reported immediately. IF IN DOUBT ASK.
 Materials not in conformity with relevant British or European Standards/Codes of practice or materials known to be deleterious to health & safety must not be used or specified on this project.

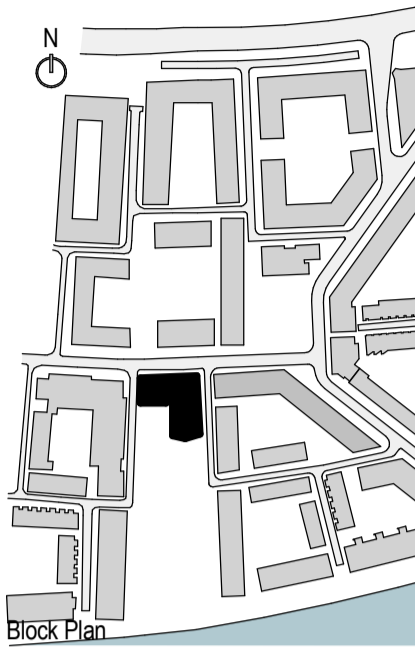

- Notes:
- Tenant to restrict waste to within store until collection. No cage external.
 - Tenant to issue design intent layout for discussion regarding drainage current proposals inadequate.
 - Tenant Riser to have access at each floor level.
 - WCEC to issue Revit model to indicate high level services & routes through tenant demise.
 - Delivery Lay-by within 50m of store entrance

- Key
- Incoming Electrics
 - Gas
 - Water
 - Drainage pop-up
 - BT
 - TV
 - FA
 - District Heating
 - Hyperoptic Fibre Cable
 - Fire Alarm
 - 160a RWP from above
 - 160a SVP from above

No	Date	Description	By	Ckd
E	27.03.19	Drainage provision updated in line with client request dated 27.03.19	DRJ	DRJ
D	21.03.19	Updated to co-ordinate with TCL Incoming services design.	DRJ	DRJ
C	05.02.19	Drainage Pop Up's amended in line with PB&C comments received 05.02.19	DRJ	DRJ
B	05.02.19	Drainage Pop Up's updated following receipt of PB&C Mark Up received 30.01.2019	DRJ	DRJ
A	13.02.18	Additional refuse storage added to commercial units	OG	CJ



PROJECT
 ROYAL WHARF, DEVELOPMENT PHASE 2B

TITLE
 Plot 12.01 - Unit 12.03 Plan

DRAWING STATUS
 FOR INFORMATION

DRAWN	IW	CHECKED	CJ
SCALE	1 : 50 @ A1		
DATE	MARCH 2017		

Whittam Cox ARCHITECTS
 Formerly WCEC architects

Chesterfield / 01246 260 261
 London / 02033 880 019
 Leeds / 0113 468 2450
 whittamcox.com

JOB NO.	DRAWING NO.	REV
14-019	A_00_12_01_302	E

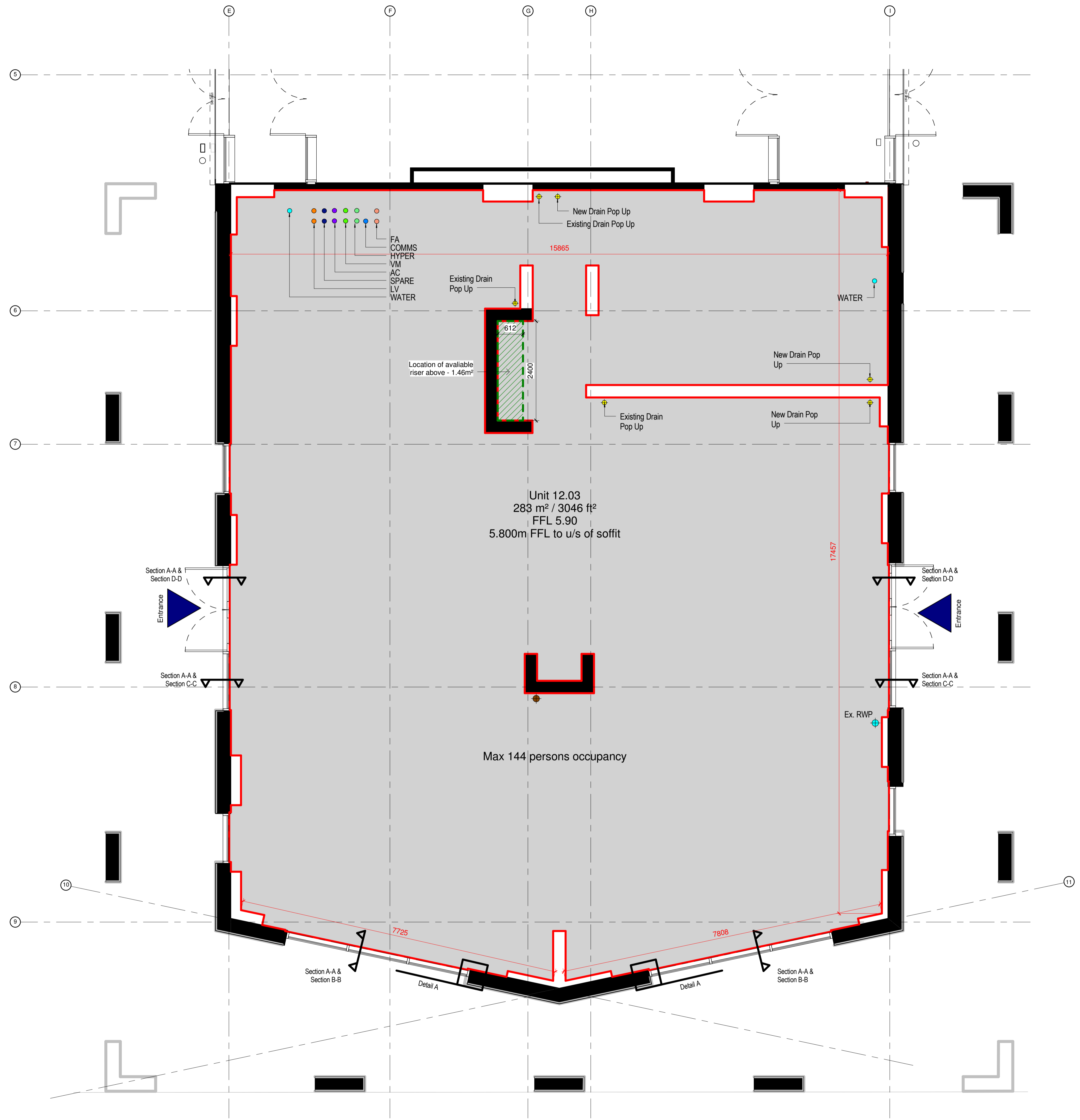

2 Plot 12.03 - Additional refuse storage - housed to at the base of plot 9.01
 1:50

