

© Whittam Cox Architects - Disclaimer
 This drawing is copyright of WCEC Group Ltd trading as Whittam Cox Architects, and shall not be reproduced nor used for any other purpose without the written permission of the Architects. This drawing must be read in conjunction with all other related drawings and documentation. It is the contractor's responsibility to ensure full compliance with the Building Regulations. Do not scale from this drawing, use figured dimensions only. It is the contractor's responsibility to check and verify all dimensions on site. Any discrepancies to be reported immediately. IF IN DOUBT ASK.
 Materials not in conformity with relevant British or European Standards/Codes of practice or materials known to be deleterious to health & safety must not be used or specified on this project.

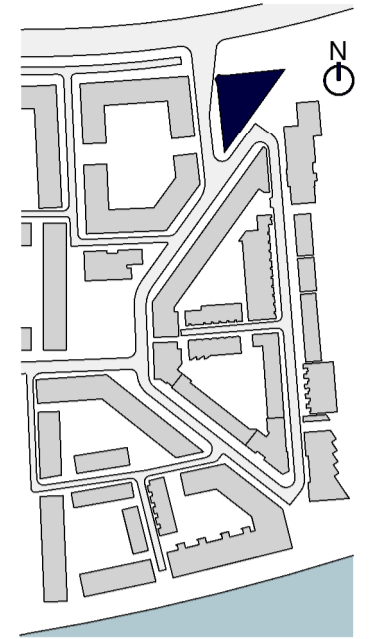

Block Location Plan

- High level containment route
- Gas
- Water
- Drainage pop-up
- Elec
- BT
- TV
- FA Panel
- District Heating
- ⊗ SVP - No connection point
- ⊙ SVP - Dedicated connection point above ground
- ⊗ RWP
- ⊗ Gully

All service locations to be confirmed by M&E engineer.

Tenant to restrict waste to within store until collection. No cage external.

Tenant to issue roof plan details.

Landlord to confirm vent strategy

Landlord to ensure all service openings through compartment party walls are fire stopped and sealed

Landlord to ensure opening in locations where riser is over the unit opening to riser to be fire stopped and sealed

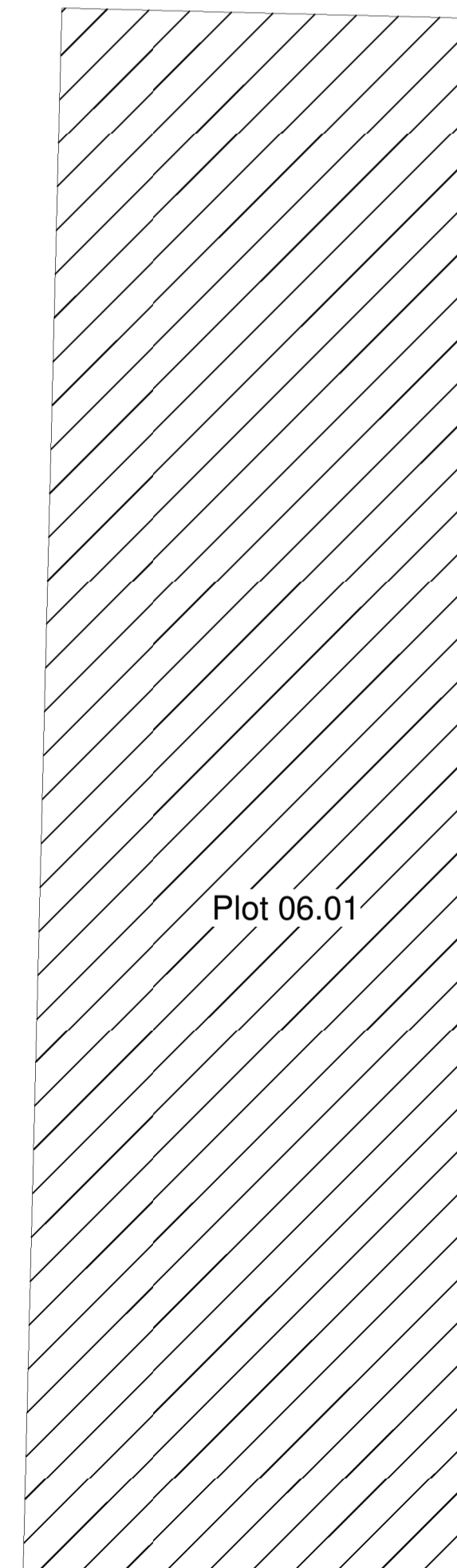
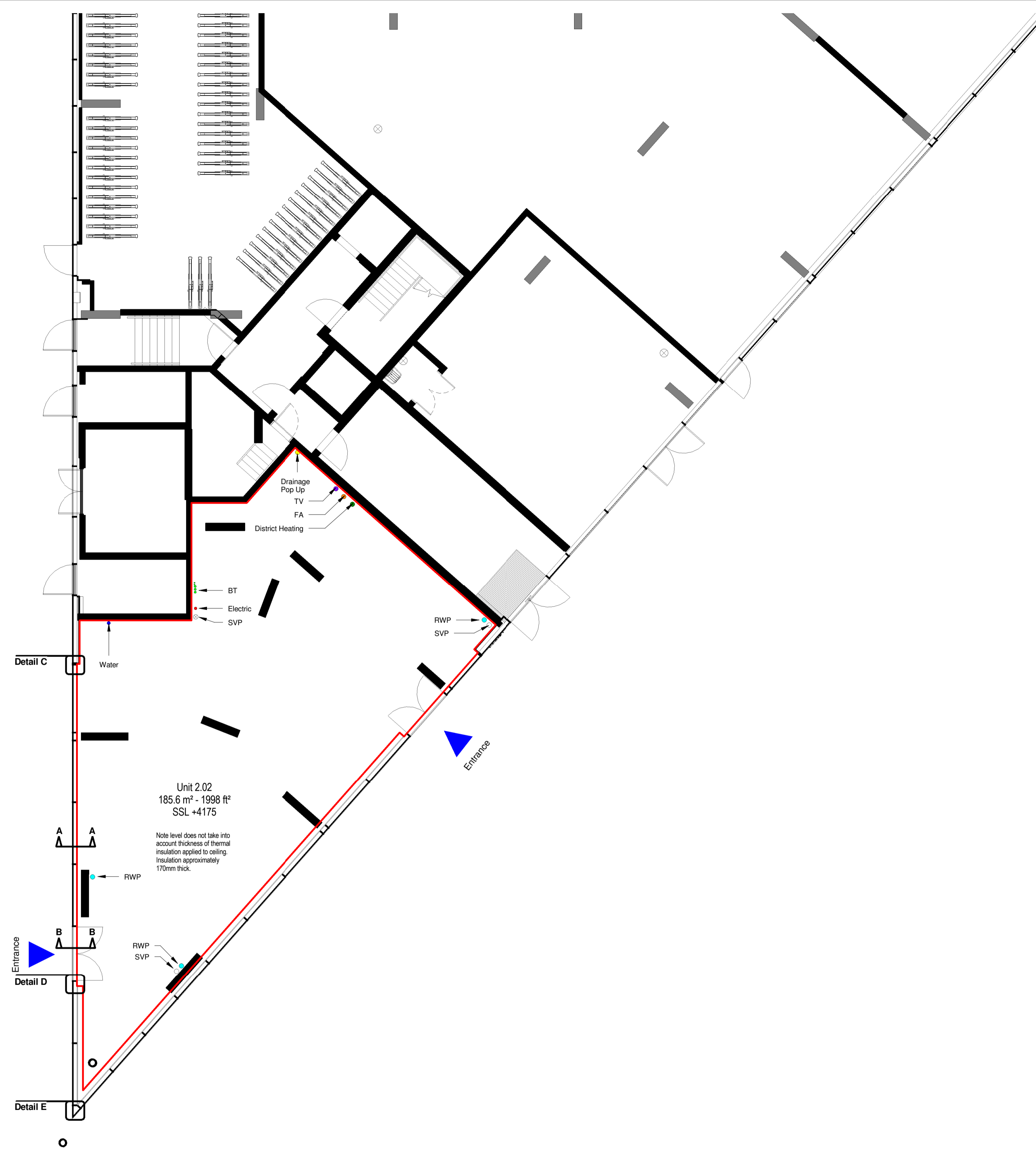

E	03/05/18	Drawing updated	SH	CH
D	05/03/18	Drainage locations revised in line with Tate survey.	IW	JH
C	09/03/17	Services updated	LO	CH
B	17.01.17	Incoming gas and water locations corrected.	GT	CH
A	07/07/16	Update for inclusion in tenant pack.	IW	CH
No	Date	Description	By	Ckd



PROJECT
 Plot 02.01 - Royal Wharf Development Phase 1

TITLE
 Plot 02.01 - Commercial Unit B Plan

DRAWING STATUS
 FOR INFORMATION

DRAWN	JS	CHECKED	CH
SCALE	As indicated @ A1		
DATE	18/01/16		

Whittam Cox ARCHITECTS Formerly WCEC architects whittamcox.com
 Chesterfield / 01246 260 261
 London / 02033 880 019
 Leeds / 0113 468 2450

JOB NO.	DRAWING NO.	REV
13-500	A_00_02_01_302	E